

**SIMON says: "Enough MP, let's look at this AC3 differenziale."**





## **Note by Olandese Volante**

- **Qualche notizie sul differenziale.**
- 
- **Per il rimontaggio in modo facile ci vuole che i “viti”non ci stanno piu.**
- 
- **La guarnizione del asso nel carter grande con ‘spline’ e 15,55 mm esterno**
- **Usare quello vecchio guarnizione pare la cosa da fare visto che non ci sta movimento e il olio non arriva a questo livello.**
- 
- **La guarnizione1 deve essere visto come A4 quando e stampato.**
- 
- **Prima di montare i cuscinetti del differenziale si pulisce le sedie con carta vetrata 1200.(foto PD004)**
- 
- **Prima di montare si riscalda il carter grande (ca 30-40 gradi) un po di lubrificante teflon non fa male.**
-

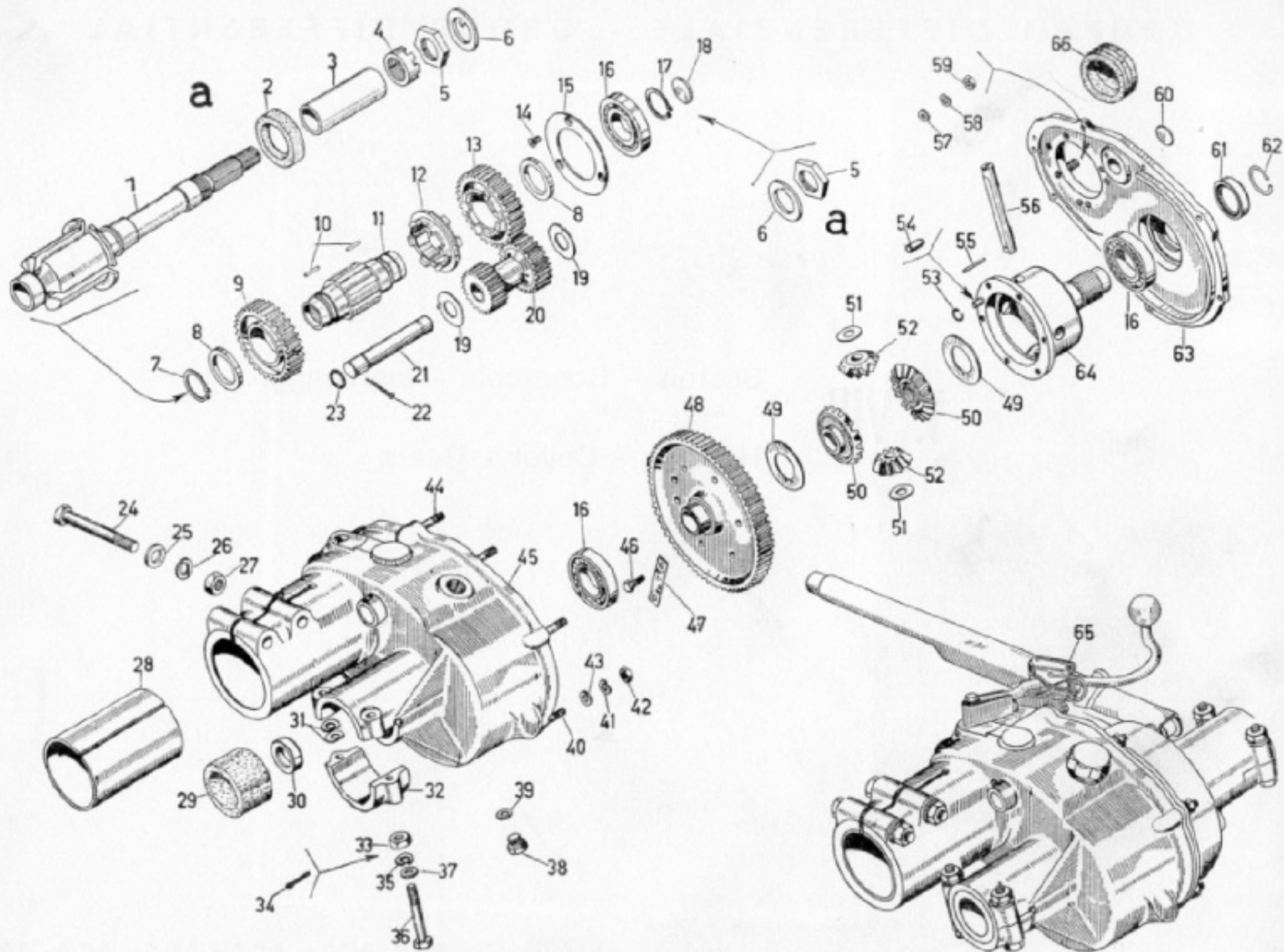

a) - Solo per veicoli mod. AC 1 — a) - Specific for mod. AC 1.



















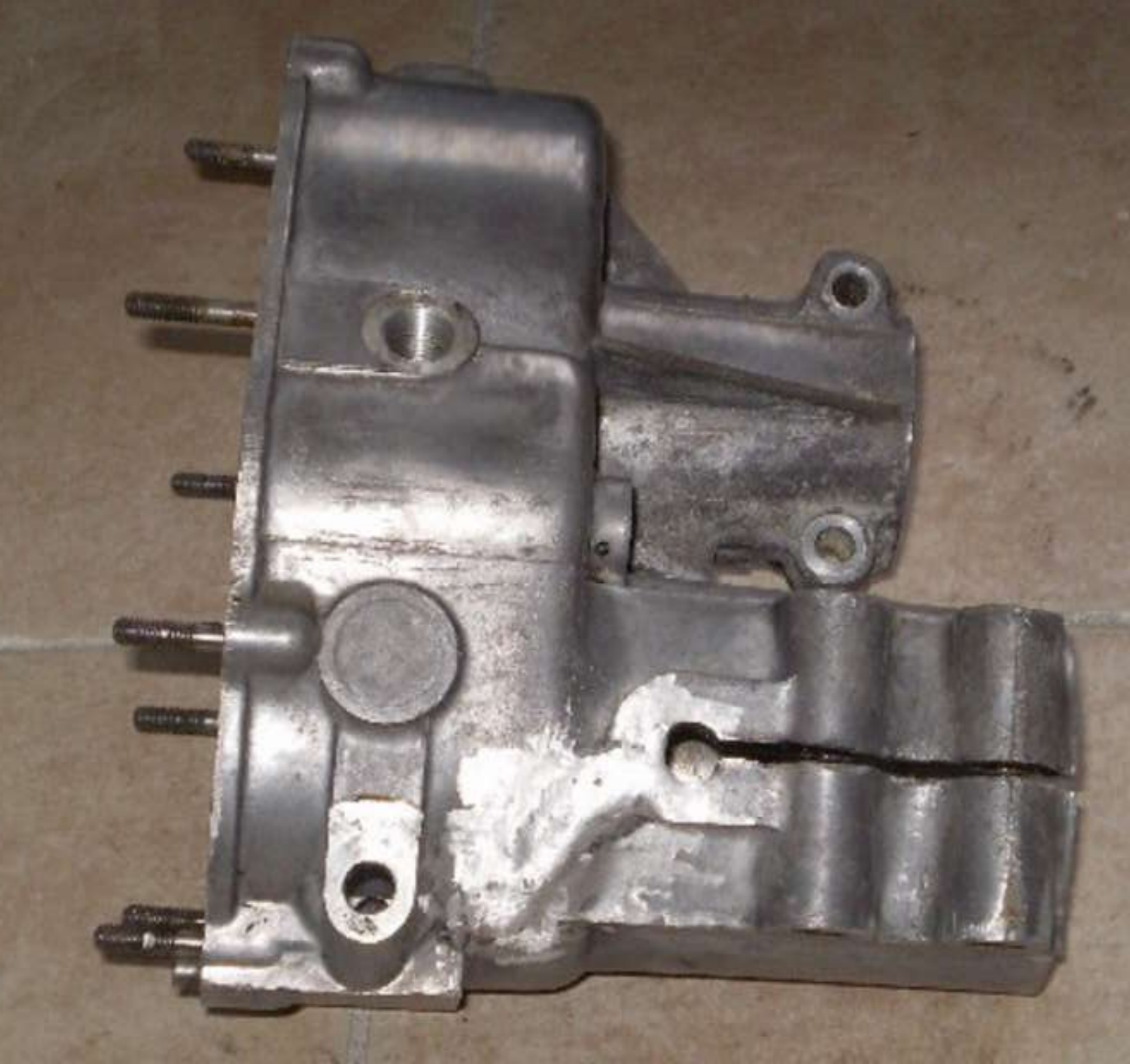





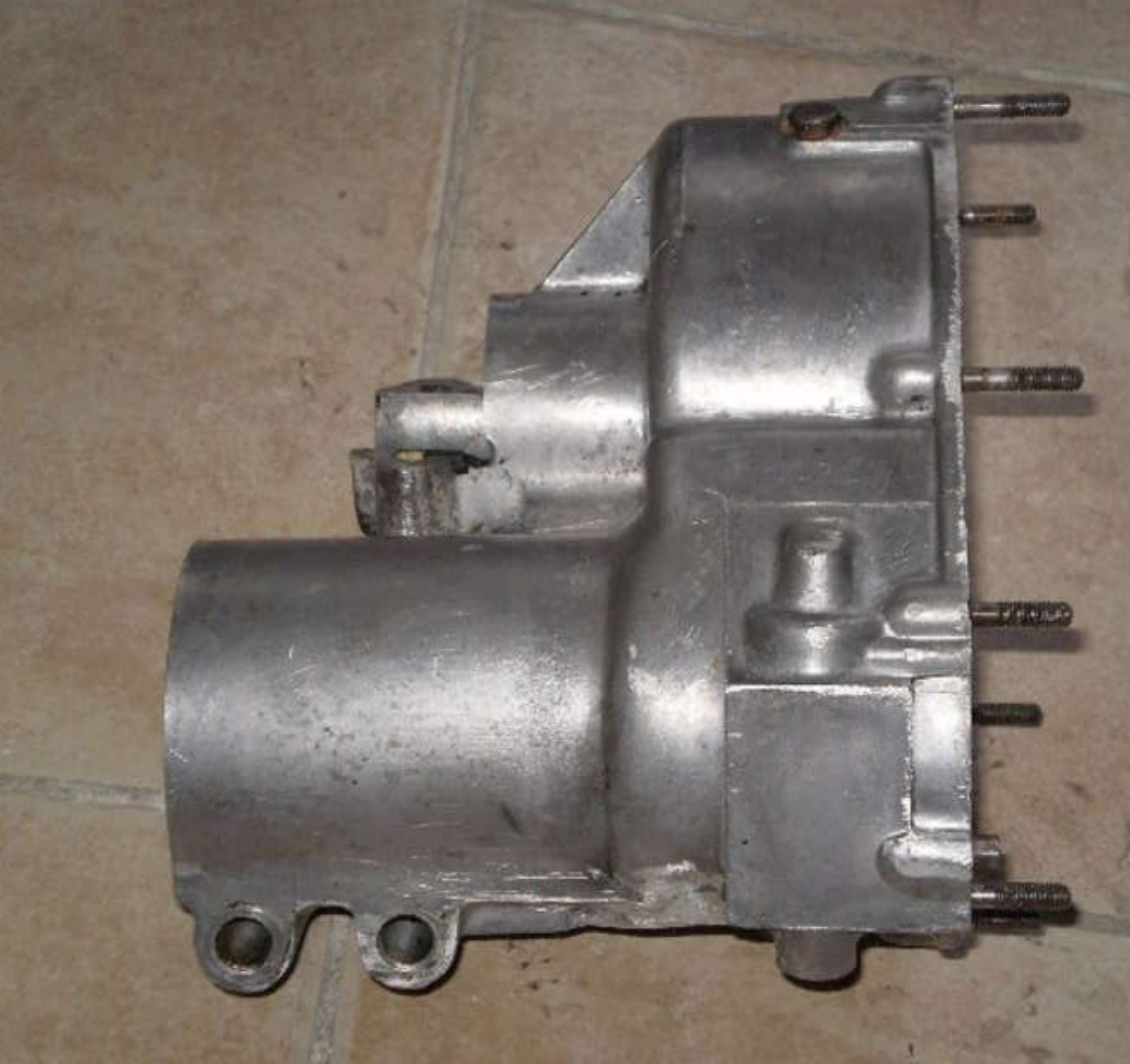





















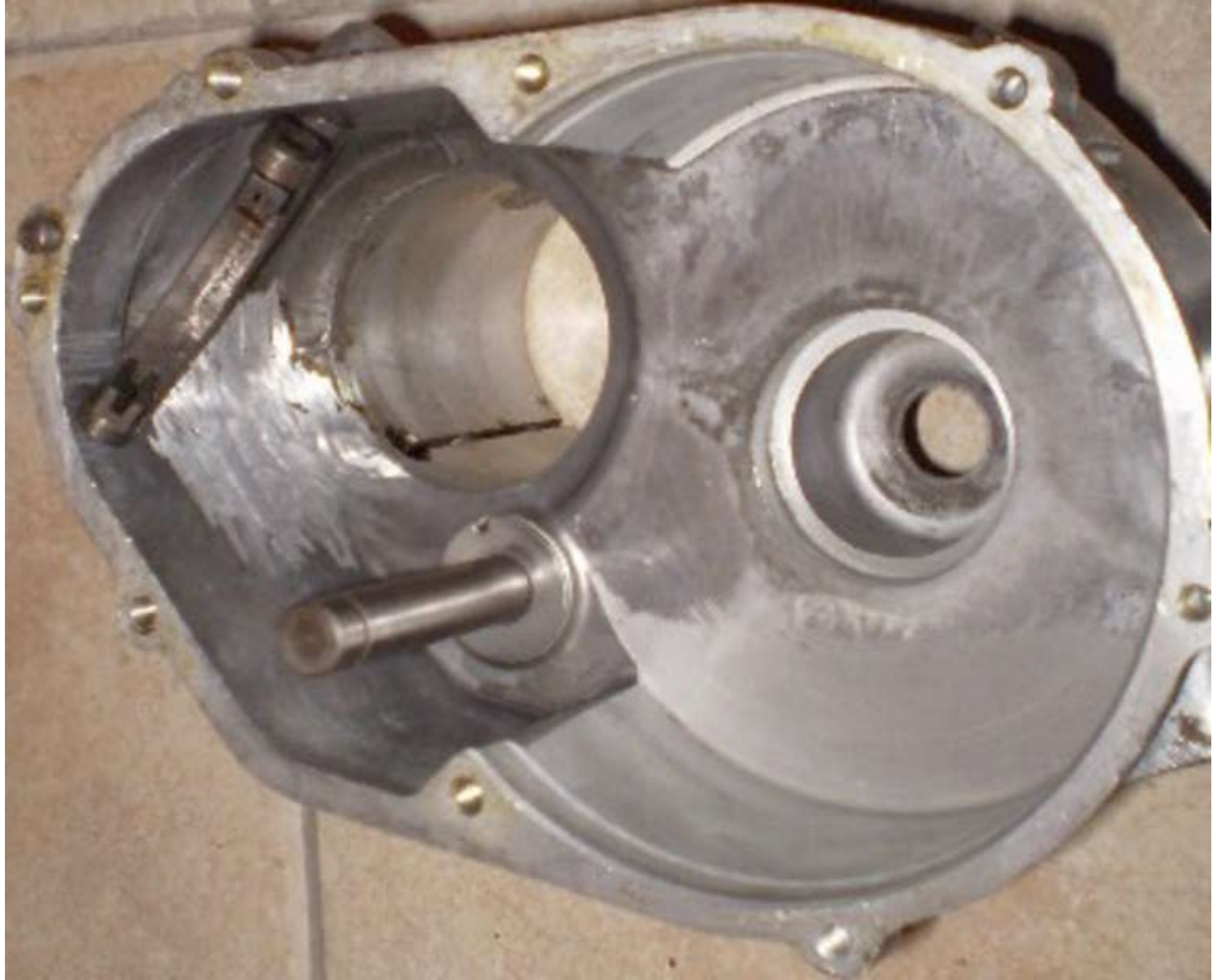























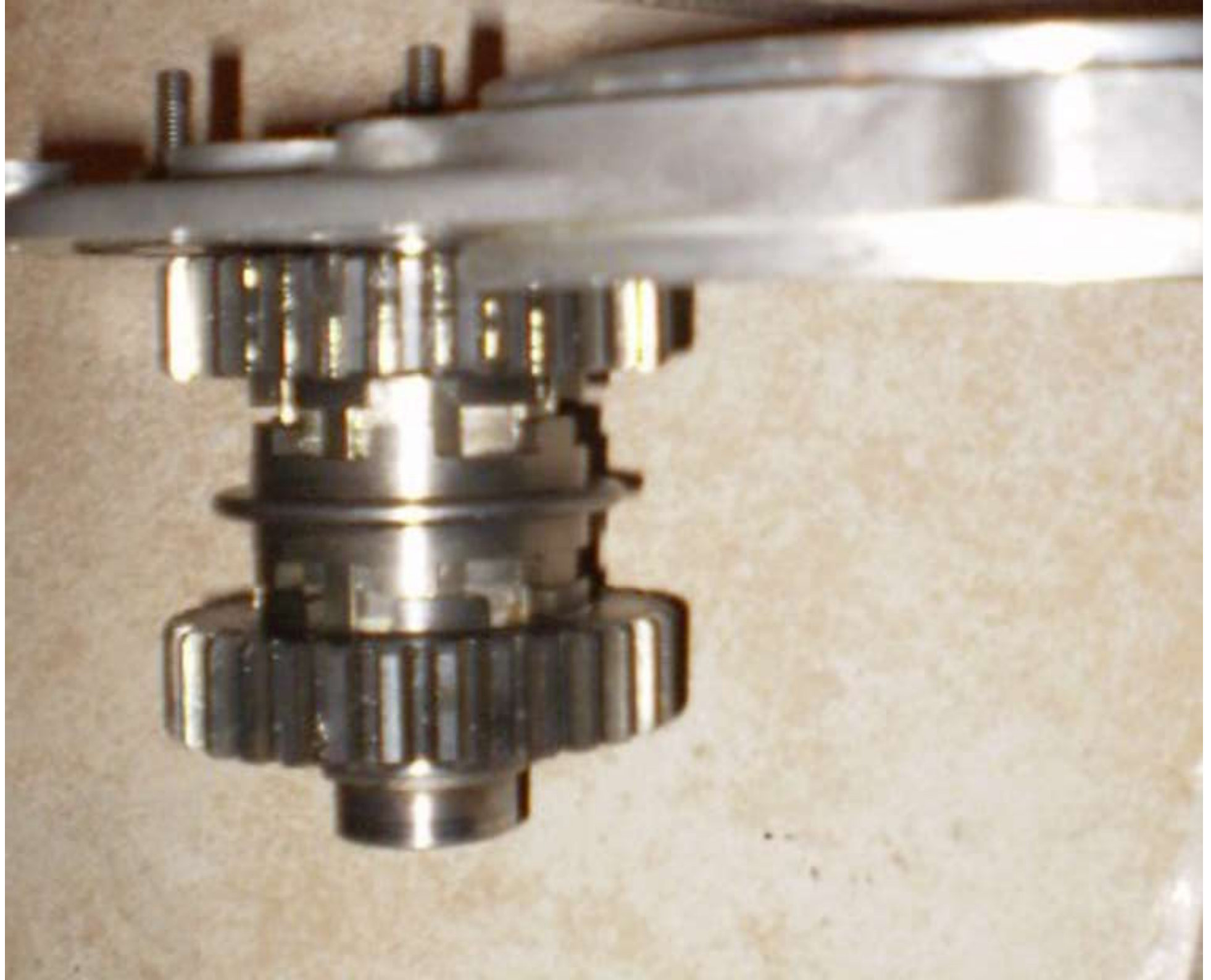

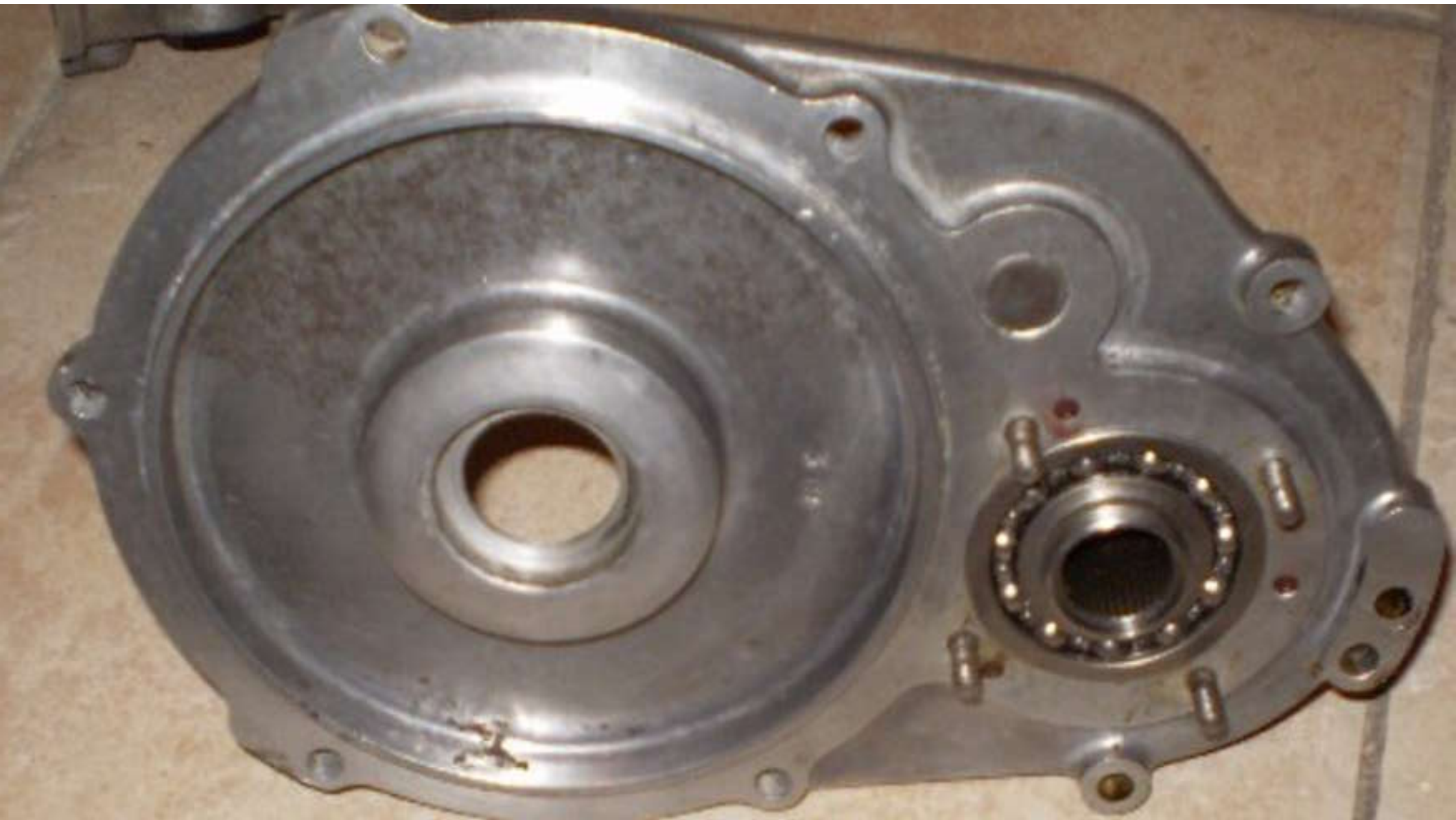



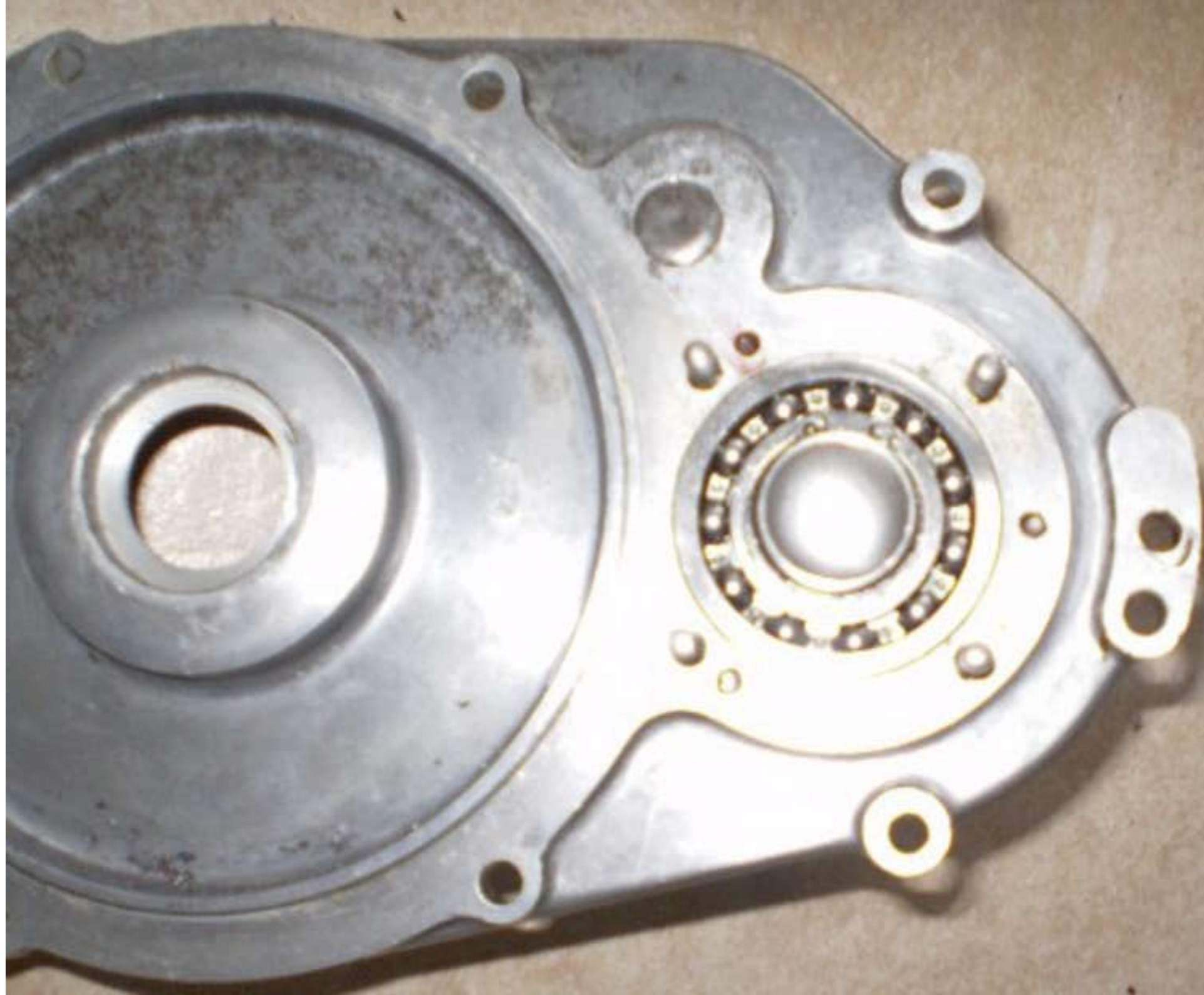







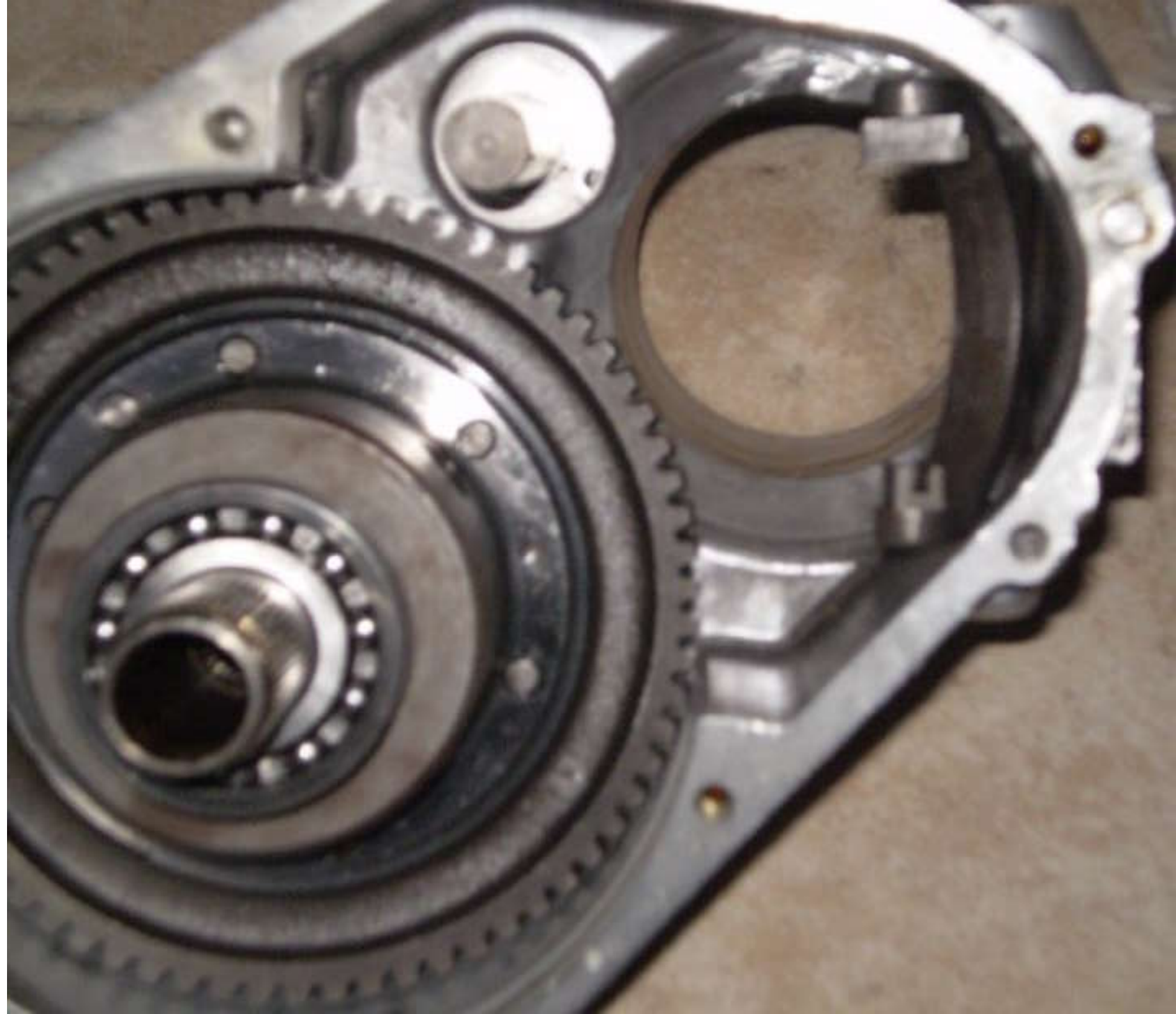







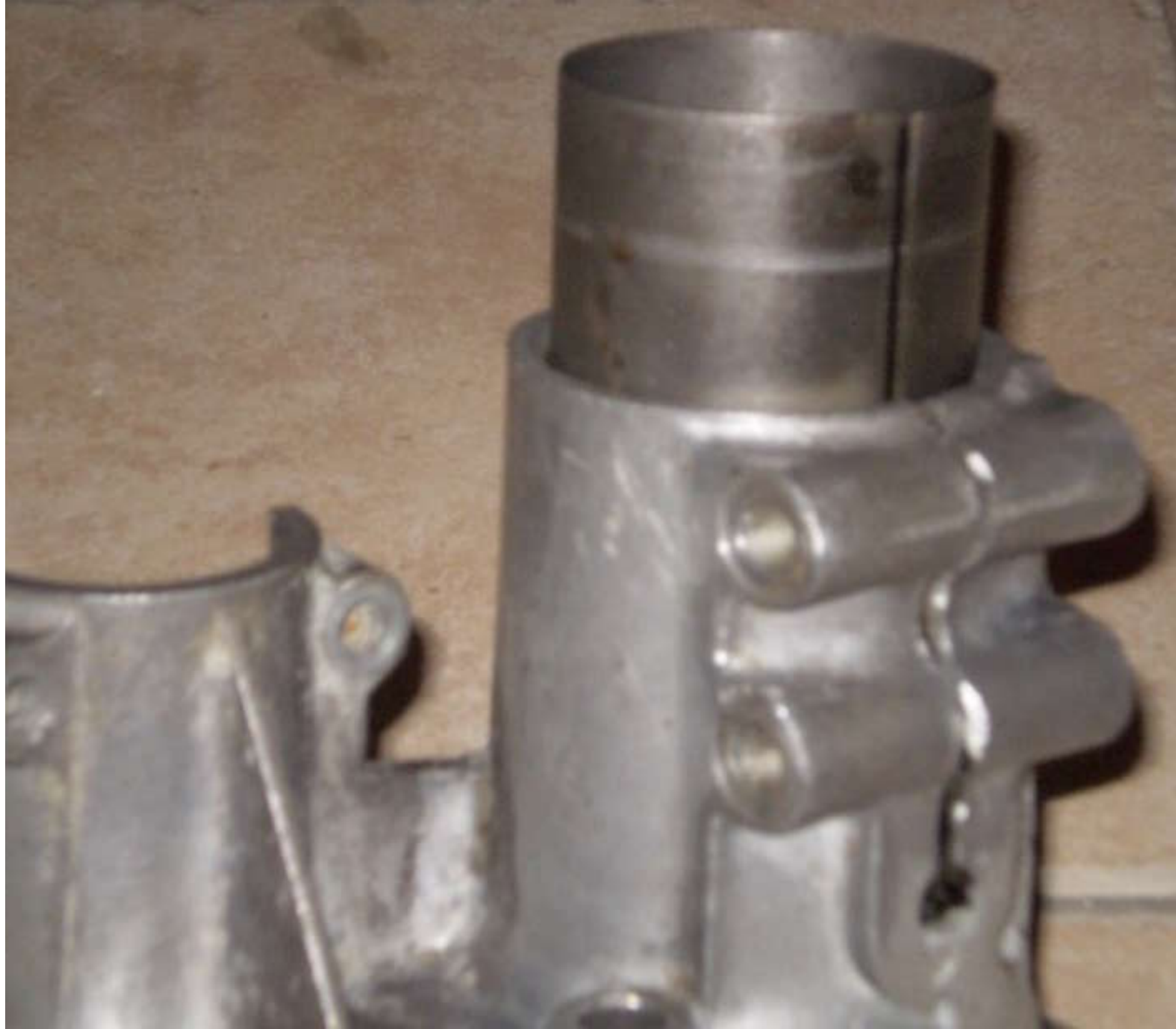



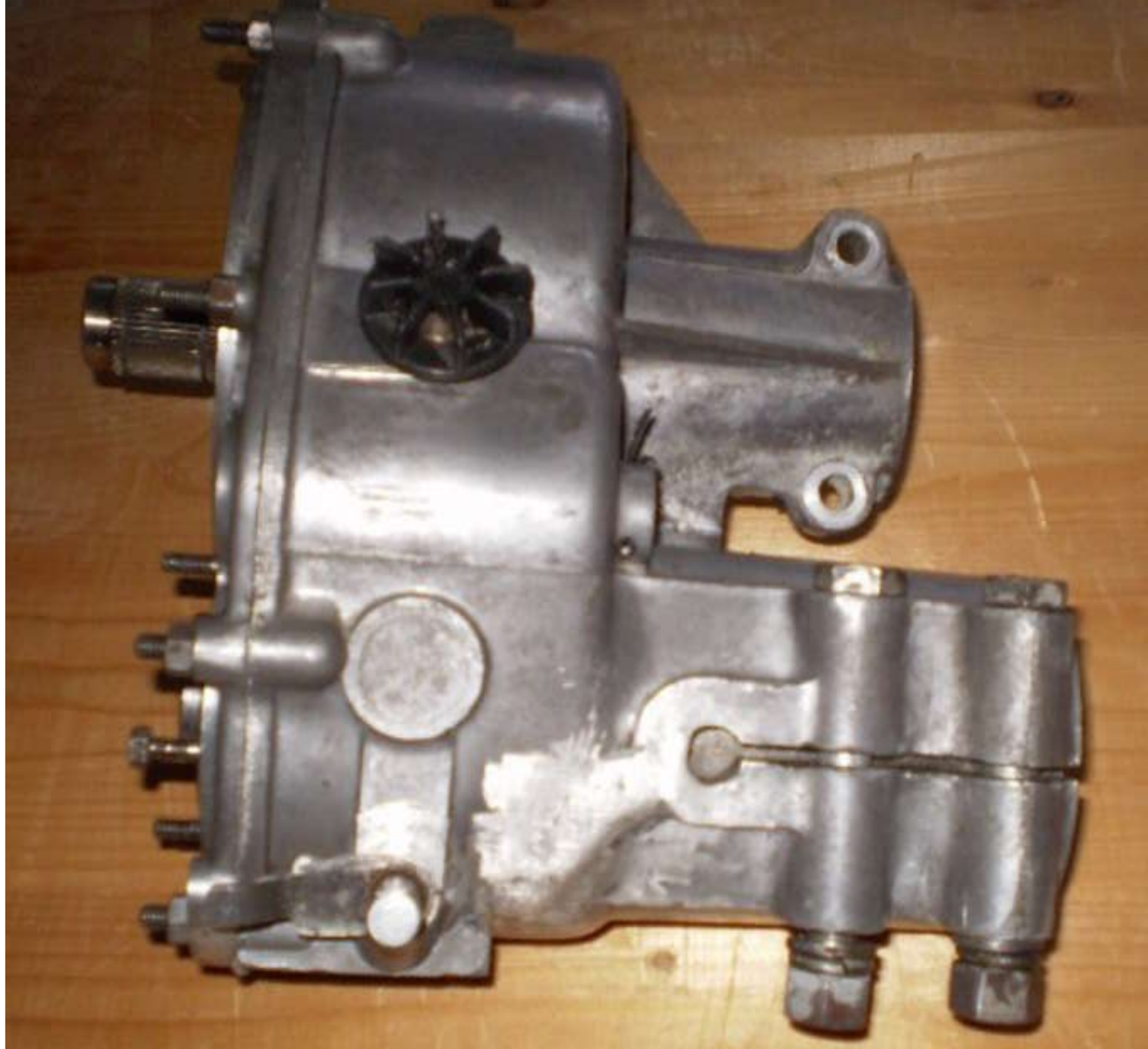



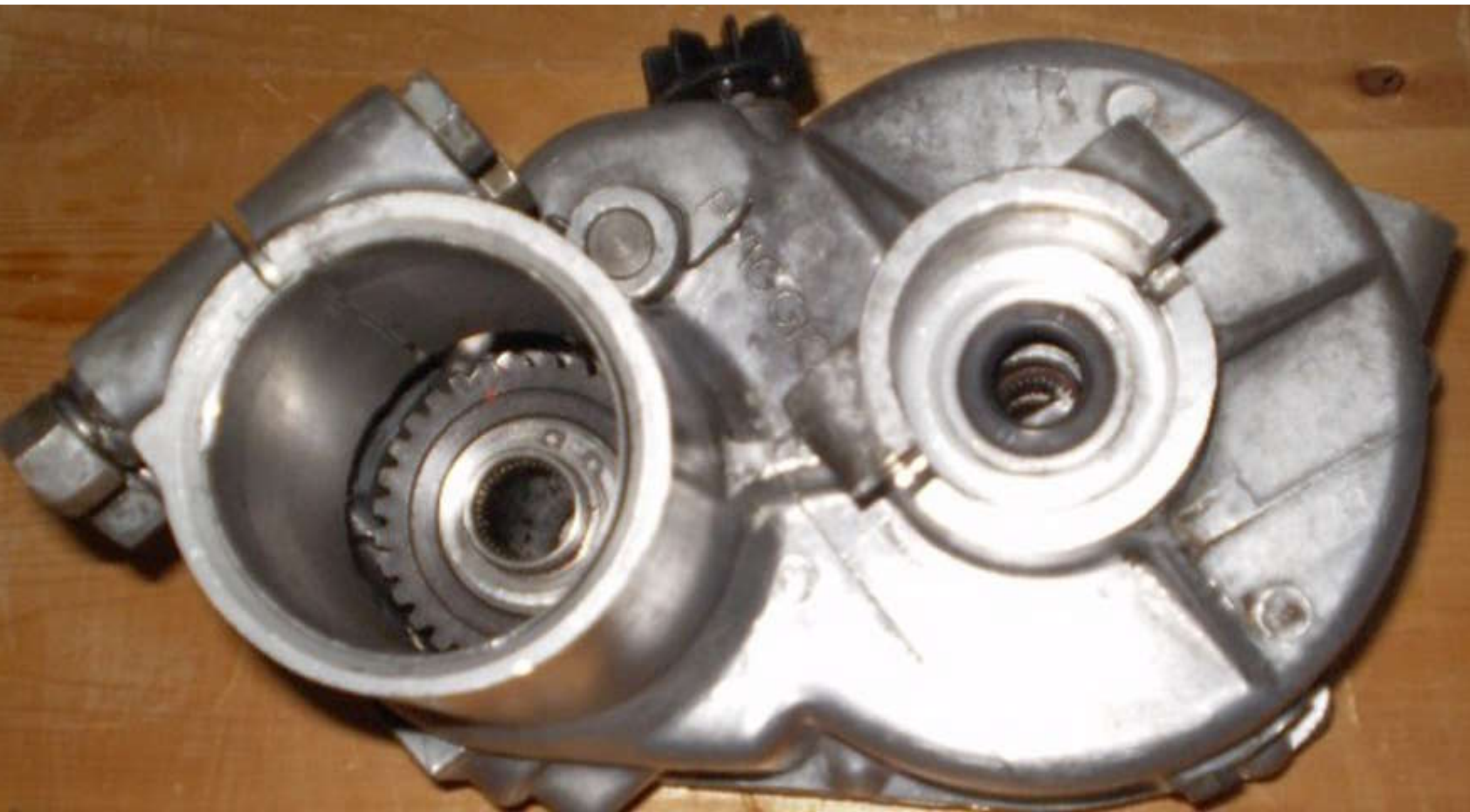



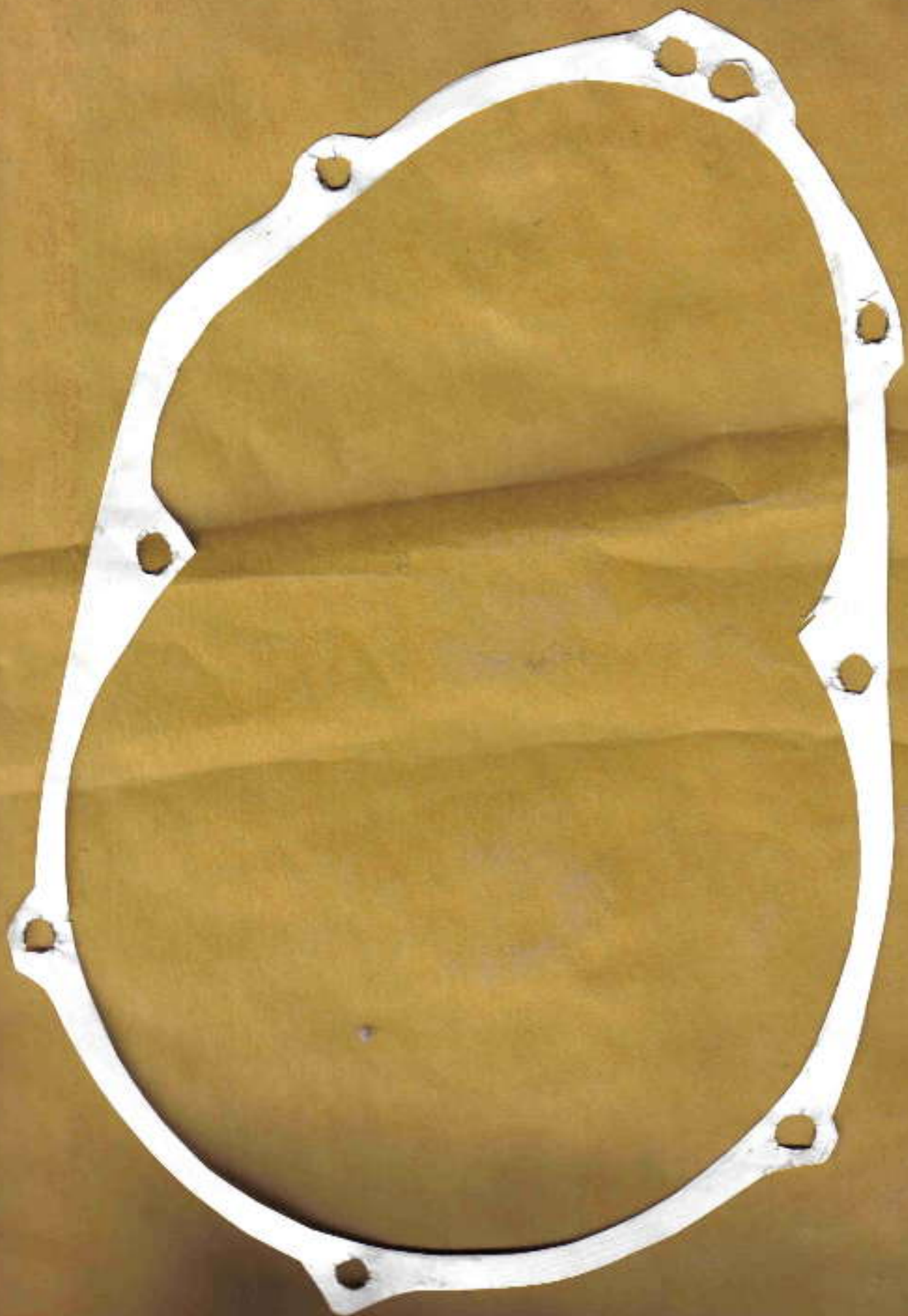

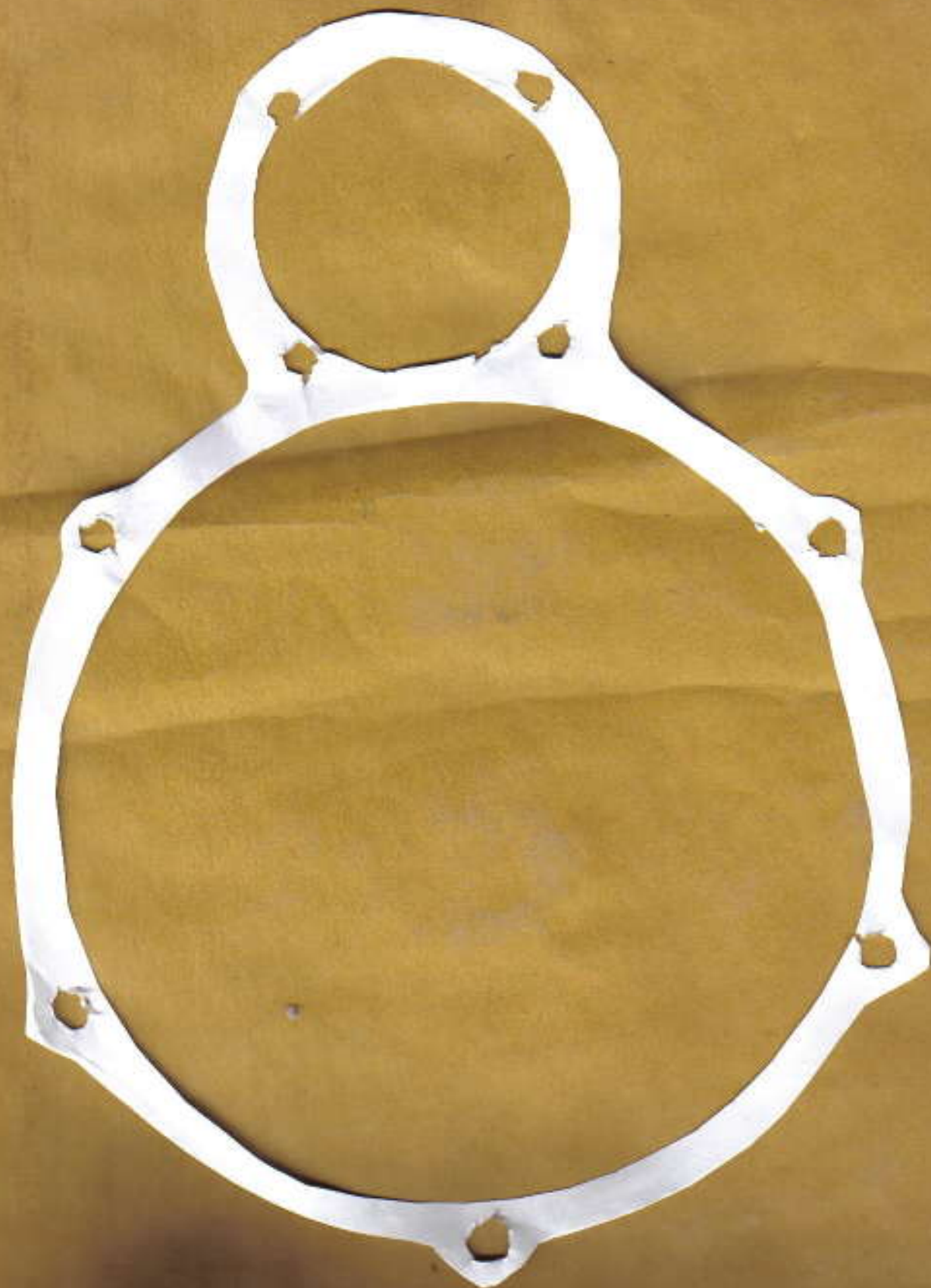

























**SIMON says: “ Finished! Time for a nap, I’m worn out. Thank O.V. for the photos.”**

